

Lowrider Light

Instruction Manual

LT005

Please read all instructions before installing your new headlight.

Warning

Failure to install accessories properly may result in damage to your bicycle, serious injury, and/or death.

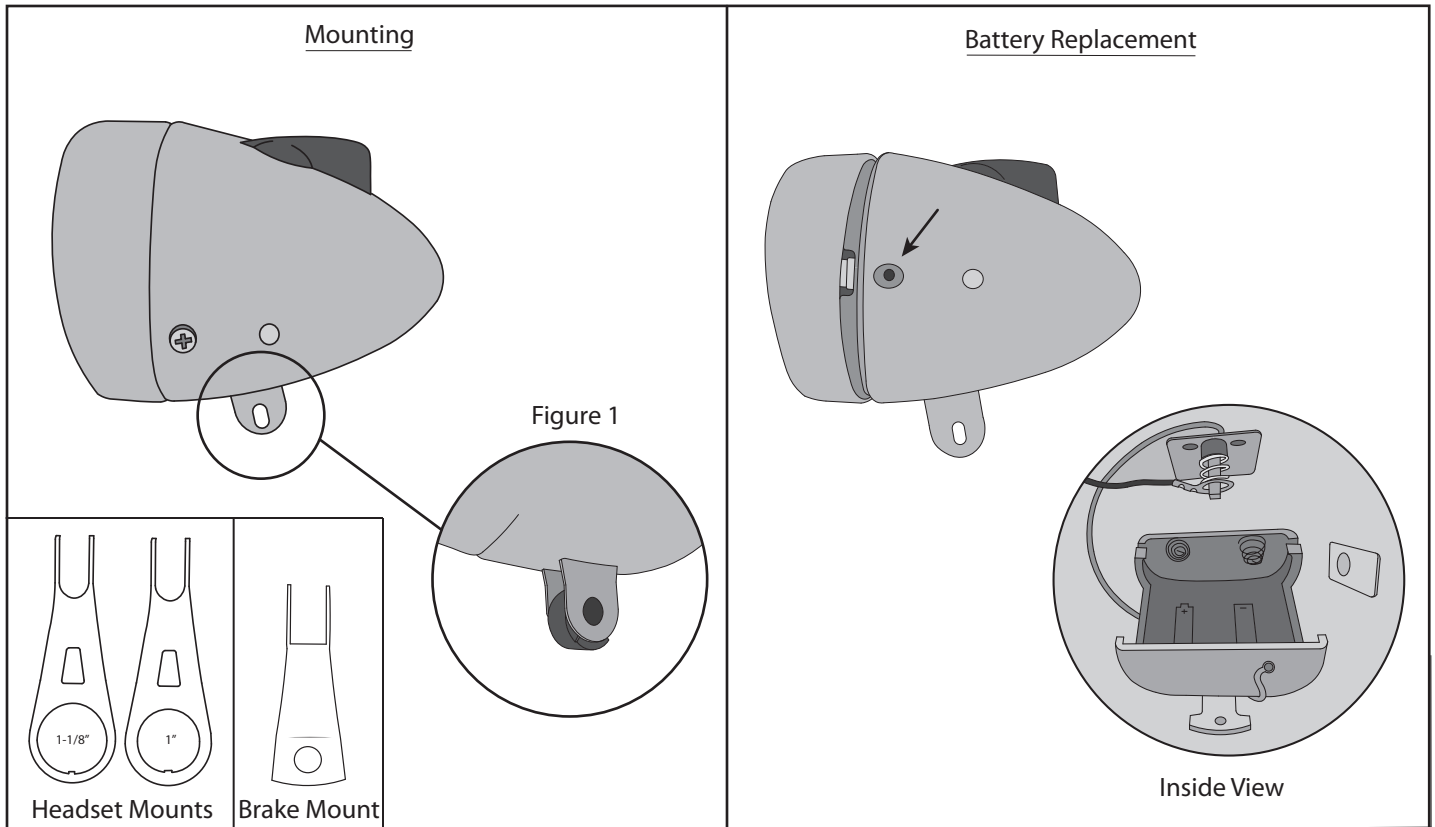

Installation

1. Insert the black circular spacer between the prongs located on the bottom of the light housing. **(Figure 1)**
2. Three types of mounts are included. 1" and 1-1/8" headset mounts, as well as a brake boss mount.
3. Choose the appropriate mount and secure the mounting arm to the light body with supplied hardware.
4. Mount light unit and arm to brake boss or headset.

Battery Replacement

1. Remove the screw indicated by the arrow above, after removal use the screw or other small tool to release the door latch by pushing inward on the housing surrounding the screw hole.
2. Replace batteries using two C-Cell batteries taking note of negative and positive orientation.
3. Close cover and replace screw.

SUNLITE