

Cartidge Bearing Threadless Headset

Instruction Manual

HS012

Please read all instructions before installing your new threadless headset.

Warning

Failure to install headsets properly may result in damage to your bicycle, serious injury, and/or death.

Note: Installation requires specialized equipment to press fittings onto the steerer tube and into the head tube.

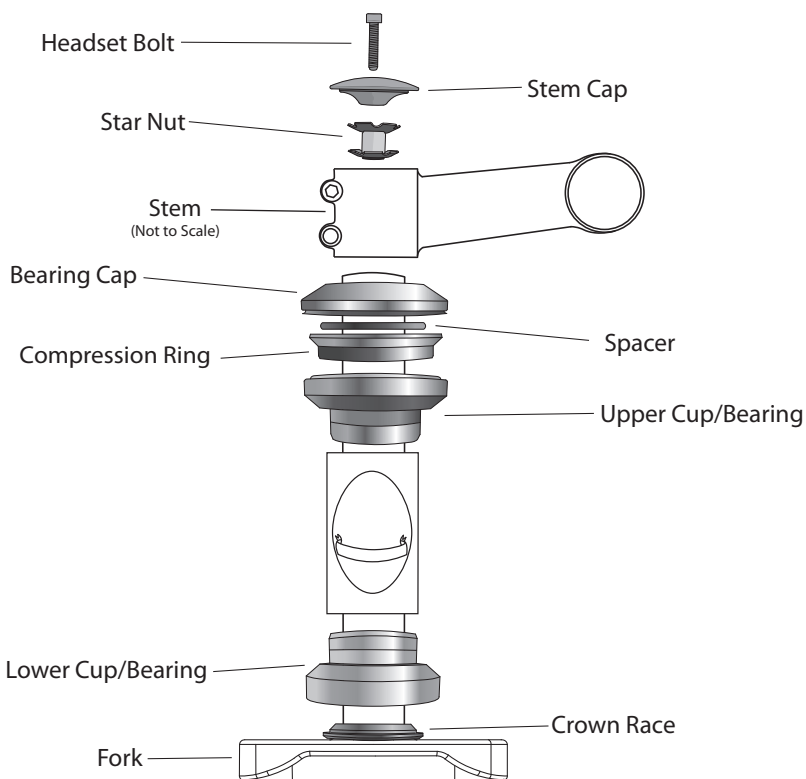

Note: This package contains 2 sizes of crown race, 26.4mm and 27mm. Be sure to check the fork for appropriate sizing.

Installation

1. Install applicable crown race to fork using an appropriate press. Fitment should be flush and evenly seated.
2. Remove the bearings from the cups, then install upper and lower cups to the head tube using a headset press and replace the bearings.
3. Using a nut setter, install the star nut into the steerer tube.
4. Insert fork through the head tube and install compression ring, spacer and bearing cap. Compression ring split should be on the side of the steerer tube - NOT the front.
5. Place stem onto steerer tube using appropriate spacers (Not included) to set height.
6. Install stem cap, and headset bolt.
7. Check that all fittings are flush with their respective mounting surfaces and that rotation is smooth.