

MX Shield Fenders

Instruction Manual

FF005

Please read all instructions before installing and using your new fenders.

Warning

Failure to install fenders properly may result in serious injury/death and or damage to your bicycle.

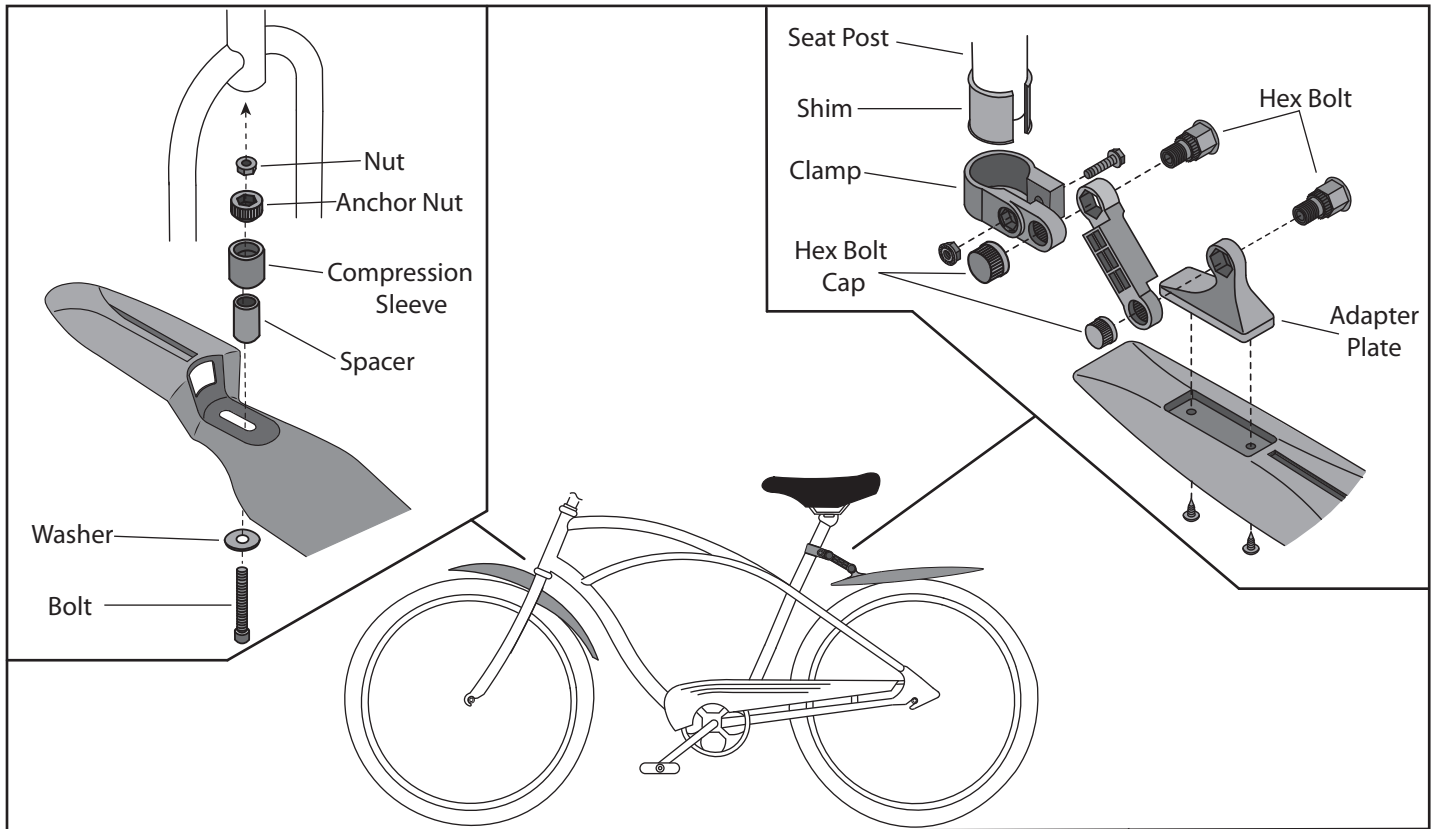

Installation

FRONT

1. Insert nut into top of anchor nut as shown.
2. Insert anchor nut into compression sleeve.
3. Place compression sleeve onto spacer and loosely secure to the fender using the bolt and washer.
4. Insert assembled pieces into the underside of the fork's steer tube and tighten bolt once assembly is fully seated.
5. Check tire and frame clearances.

REAR

1. Attach adapter plate to fender body with provided screws and set aside.
2. Install the clamp to seat post of bicycle using the included shim if necessary.
3. Place larger hex bolt cap into opening in clamp and install the arm using a hex bolt as shown to secure. Do not fully tighten.
4. Attach fender/adapter plate to the arm using the remaining hex bolt and cap.
5. Check clearances and adjust as necessary.
6. Tighten all fittings.

Note: To adjust the rear fender angle, hex bolts must be fully removed. Do not attempt to force the joints to move.

SUNLITE