

Locking Brake Lever

Instruction Manual

BL003

Please read all instructions before installing your new brake levers.

Warning

Failure to install brake levers properly may result in damage to your bicycle, serious injury, and/or death.

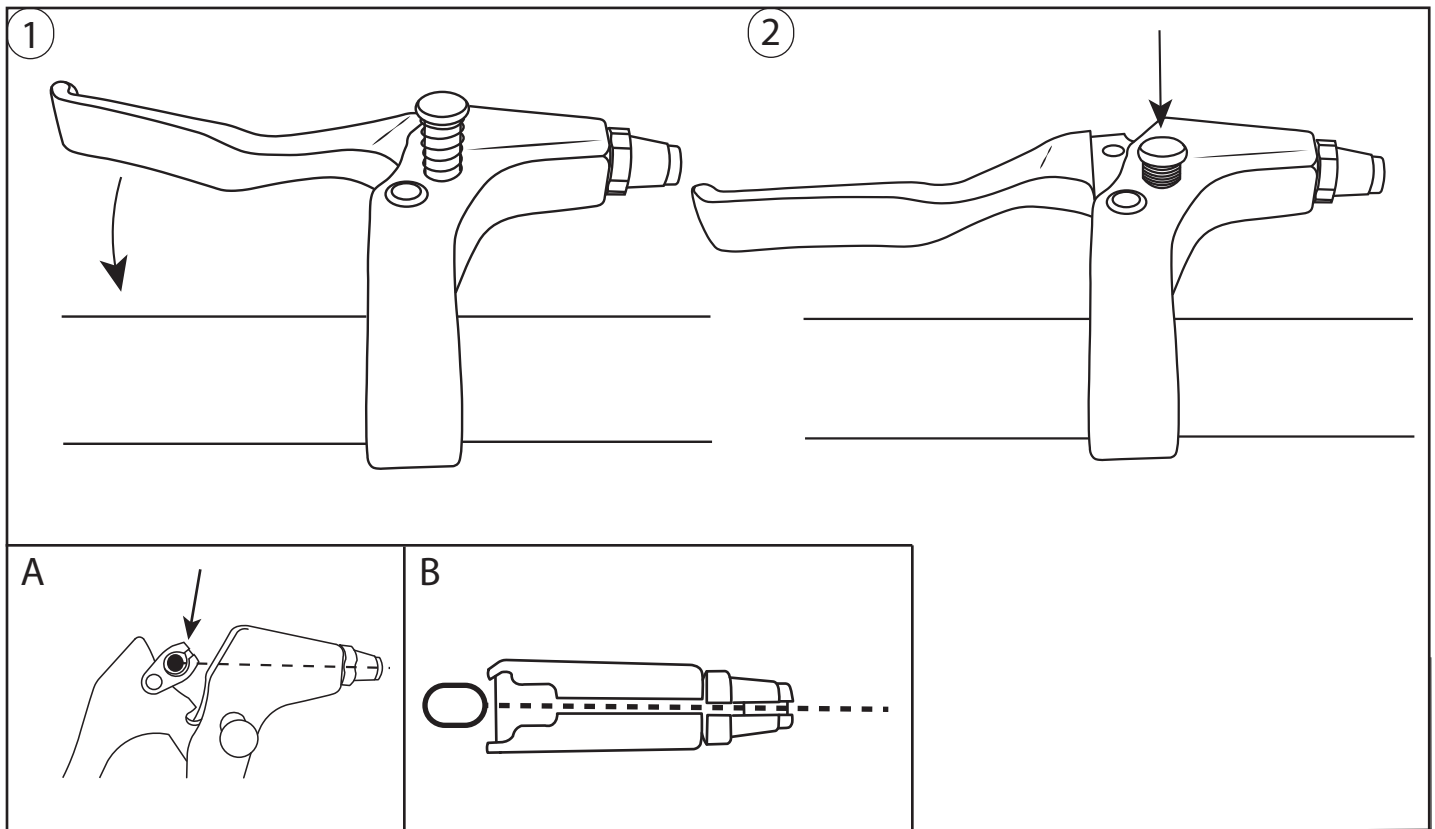

Installation/Use

1. Remove the grips from handlebar.
2. Using a 5mm allen key, loosen the bolt in the brake lever clamp.
3. Slide brake lever in place on handlebar.
4. Tighten the brake lever clamp bolt between 5 - 7 Nm.
5. Slide the grip back onto the handlebar.

Locking Mechanism

1. Pull the lever blade as if braking (1).
2. Push the button down located on the top of the lever, while it is depressed release the lever blade (2).
3. To release simply pull the lever blade again as if braking, the button should then pop up releasing the brake.

Cable Installation/Adjustment

1. To install the cable, pull the lever blade as if braking to expose the barrel well (A).
2. Insert the cable end into the holder and through the lever body by aligning the slots in the top of the lever and barrel adjuster (B), do not leave slots aligned after cable is installed.
3. Install cable to brake caliper per manufacturer's instructions and check for proper function before riding.